

HAMMOND AVENUE
(50' R.O.W.)

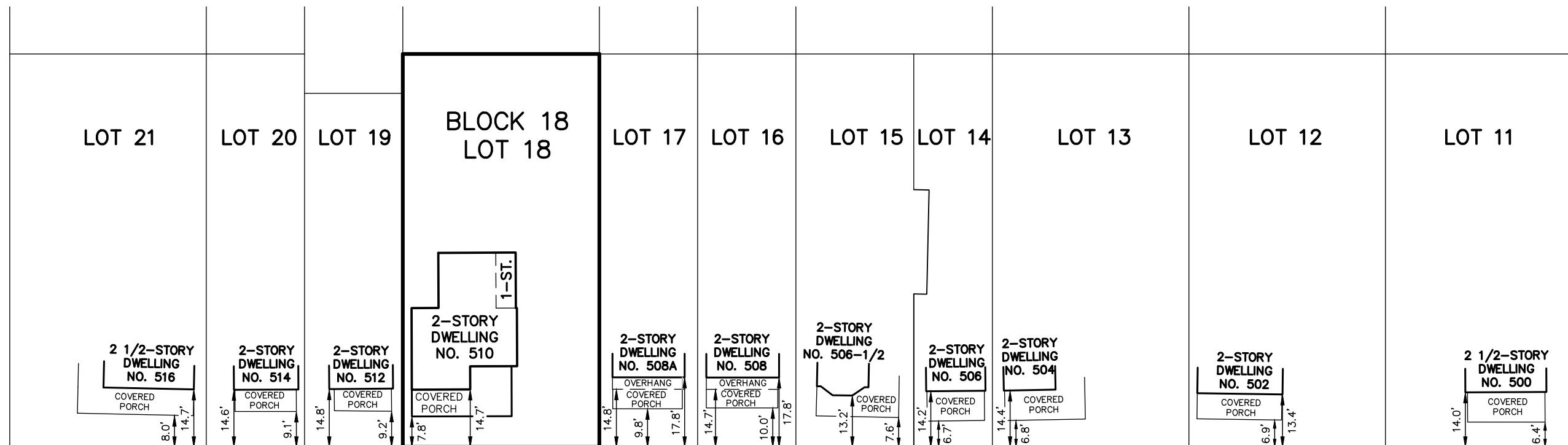

FLETCHER-LKAE AVENUE
(50' R.O.W.)

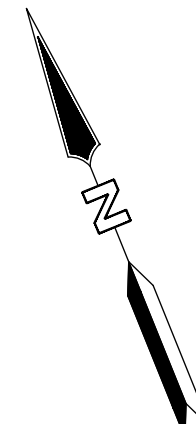

PARK PLACE AVENUE
(60' R.O.W.)

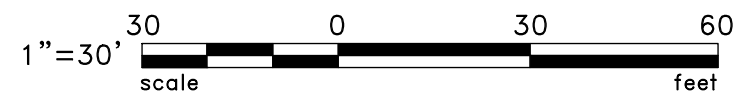

AVERAGE PORCH SETBACK - 8.9 FT.
AVERAGE DWELLING SETBACK - 14.2 FT.

| | | | |
|--|----------|-----------------|---|
| FRONT YARD SETBACK PLAN | | | |
| NORTHERLY SIDE OF PARK PLACE AVENUE BETWEEN HAMMOND AVENUE & FLETCHER-LAKE AVENUE | | | |
| BOROUGH OF BRADLEY BEACH | | MONMOUTH COUNTY | |
| NEW JERSEY | | | |
| Charles Surmonte P.E. & P.L.S. New Jersey Professional Engineer and Land Surveyor License No. 35885 | | | 301 Main Street, 2nd Floor Allenhurst, New Jersey, 07711 Phone 732-660-0606 Fax 732-660-0404 |
| PROJECT No. | DATE: | SCALE: | SHEET: |
| 24-817 | 09-09-24 | 1"=30' | 1 OF 1 |